

Do not scale drawings. Contractors must check and verify all dimensions and report any discrepancies to the Architect before proceeding with the work. All documents remain the property of the Architect. Unauthorized use, modification, and/or reproduction of these documents is prohibited without written permission. The Contract Documents were prepared by the Consultant for the account of the Owner. The material contained herein reflects the Consultant's best judgment in light of the information available to him at the time of preparation. Any use which a third party makes of the Contract Documents, or any reliance on or decisions to be made based on them are the responsibility of such third parties. The Consultant accepts no responsibility for damages, if any, suffered by any third party as a result of decisions, made or actions based on the Contract Documents.
 C:\Users\mwhite\Desktop\Locals\18025 - 354 King St, Hamilton - V10.0_mWhite66EDL.rvt

AMENITY AREA (SEE DRAWINGS A7.3, 7.4, 7.5, AND 7.6 FOR AMENITY AREA PLANS)			
AMENITY AREA FOR MULTIPLE DWELLING UNITS	6.1.3 f)	4.0 m ² FOR EACH DWELLING UNIT < 50m 4.0 m ² x 123 UNITS = 492 m ² 6.0 m ² FOR EACH DWELLING UNIT < 50m 6.0 m ² x 199 UNITS = 1194 m ² TOTAL = 1686 m ²	728.3 m ² (OUTDOOR) 1038.5 m ² (INDOOR) 1767 m² (TOTAL)
OUTDOOR AMENITY AREA(S)			DOG RUN: 135.1 m ² PATIO: 93.4 m ² PICNIC AREA A: 47.7 m ² PICNIC AREA B: 50.5 m ² 16TH FLOOR ROOF: 135.6 m ² MECH. PH ROOF: 266.0 m ² TOTAL: 728.3 m²
INDOOR AMENITY AREA(S)			STUDY/MEDIA ROOMS: 120.2 m ² LOBBY/LOUNGE: 171.0 m ² SUN ROOM SEATING AREA: 29.6 m ² YOGA STUDIO: 72.2 m ² CHANGE ROOMS: 65.5 m ² BASKETBALL COURT: 133.7 m ² FITNESS STUDIO: 127.3 m ² MECH. PH. AMENITY: 85.7 m ² ELEVATOR LOBBY(S) L2-24): 24 x 7 m ² = 168 m ² MECH. PH. ELEV. LOBBY: 65.3 m ² TOTAL: 1038.5 m²
TOTAL AMENITY AREA(S)			1767 m²

■ DENOTES AMENITY AREA

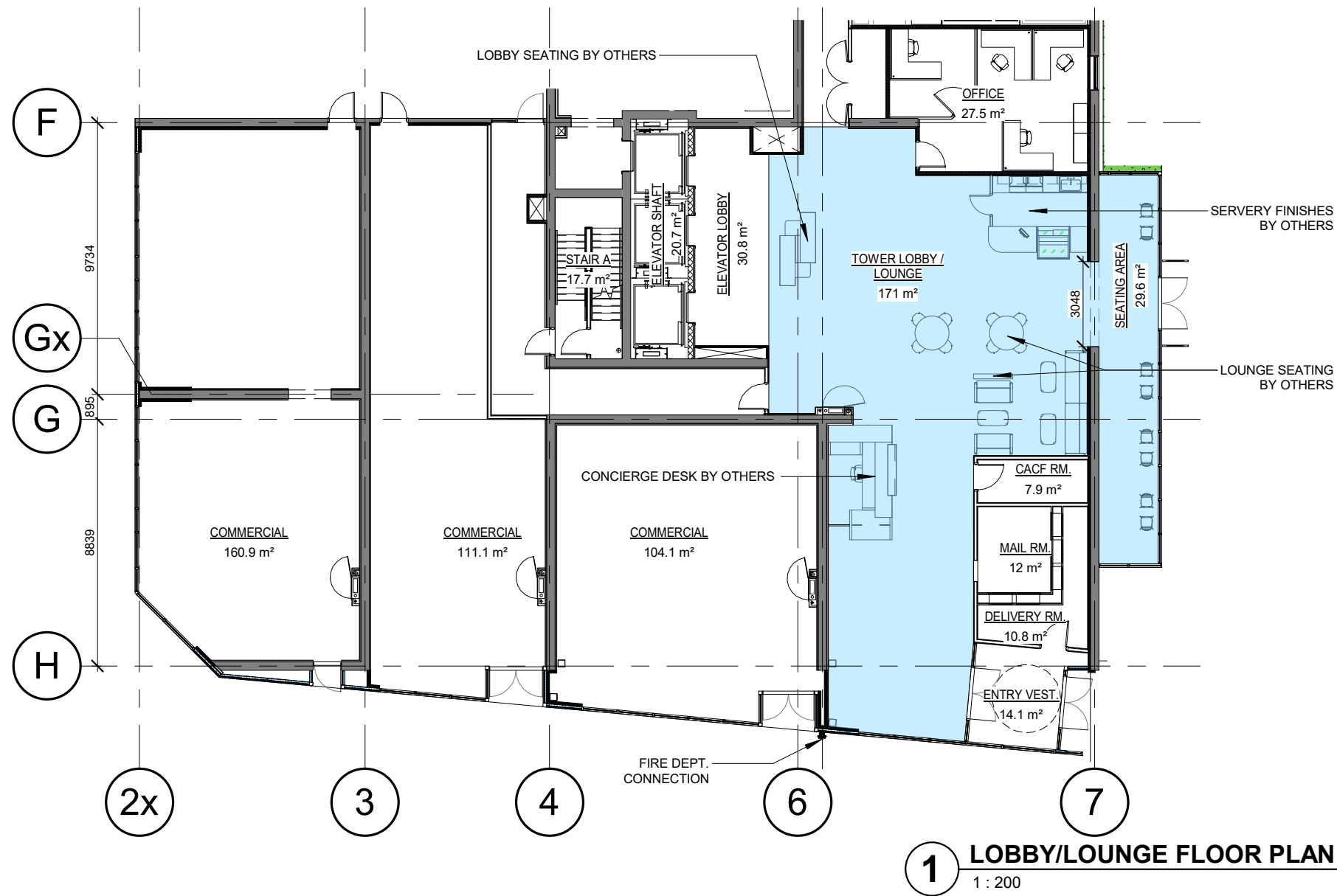

1 LOBBY/LOUNGE FLOOR PLAN
1 : 200

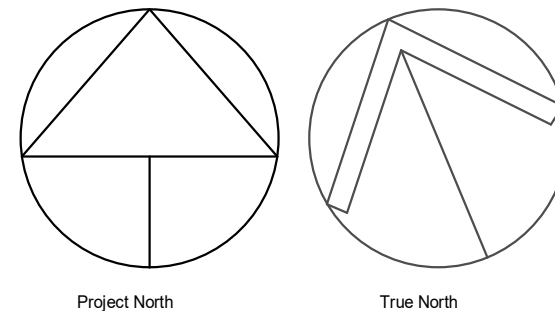

1	2019-11-27	ISSUED FOR OPA/ZBA SUBMISSION
No.	Date	Revision

Project No 18025
 Issue Date 2019-10-18
 Drawn by MSW
 Checked by TJM
 Plot Date / Time 2019-11-27 1:32:49 PM



354 KING STREET WEST

ENLARGED FLOOR PLAN - LOBBY & AMENITIES



Drawing Scale As indicated
 Status ISSUED FOR OPA/ZBA
 Drawing No.

A7.3

Do not scale drawings. Contractors must check and verify all dimensions and report any discrepancies to the Architect before proceeding with the work. All documents remain the property of the Architect. Unauthorized use, modification, and/or reproduction of these documents is prohibited without written permission. The Contract Documents were prepared by the Consultant for the account of the Owner. The material contained herein reflects the Consultant's best judgment in light of the information available to him at the time of preparation. Any use which a third party makes of the Contract Documents, or any reliance on or decisions to be made based on them are the responsibility of such third parties. The Consultant accepts no responsibility for damages, if any, suffered by any third party as a result of decisions, made or actions based on the Contract Documents.
 C:\Users\mwhite\Desktop\Locals\18025 - 354 King St, Hamilton - V10.0_mwhite06EDL.rvt

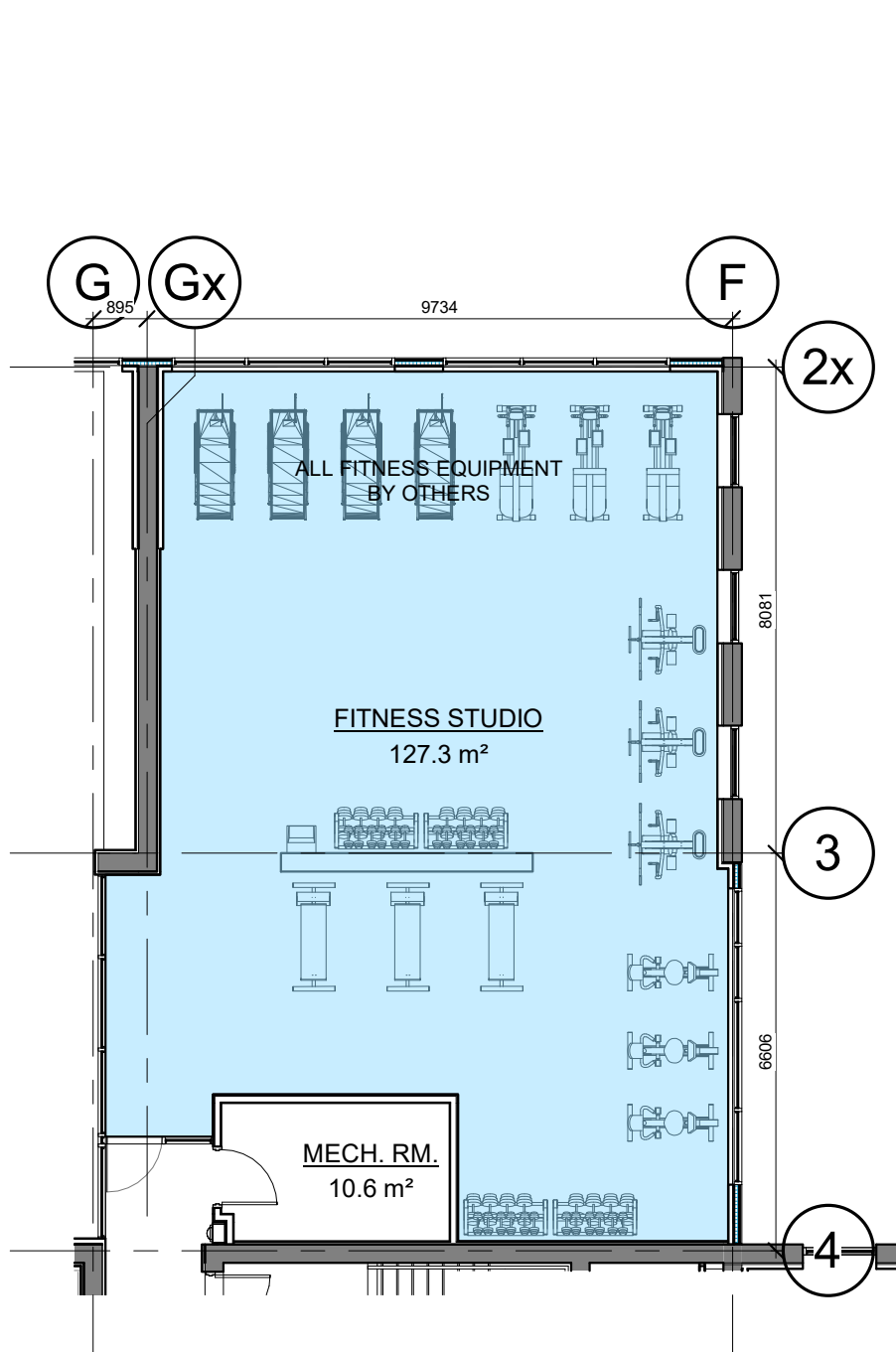
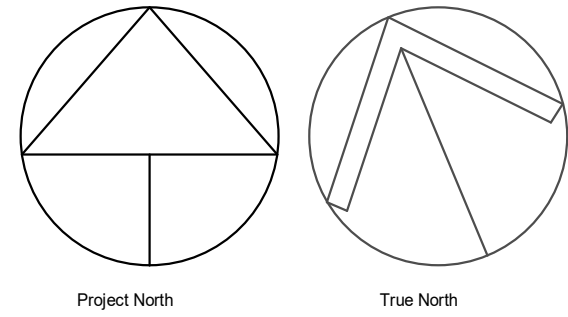

2 LEVEL 15 AMENITY SPACE
1 : 125

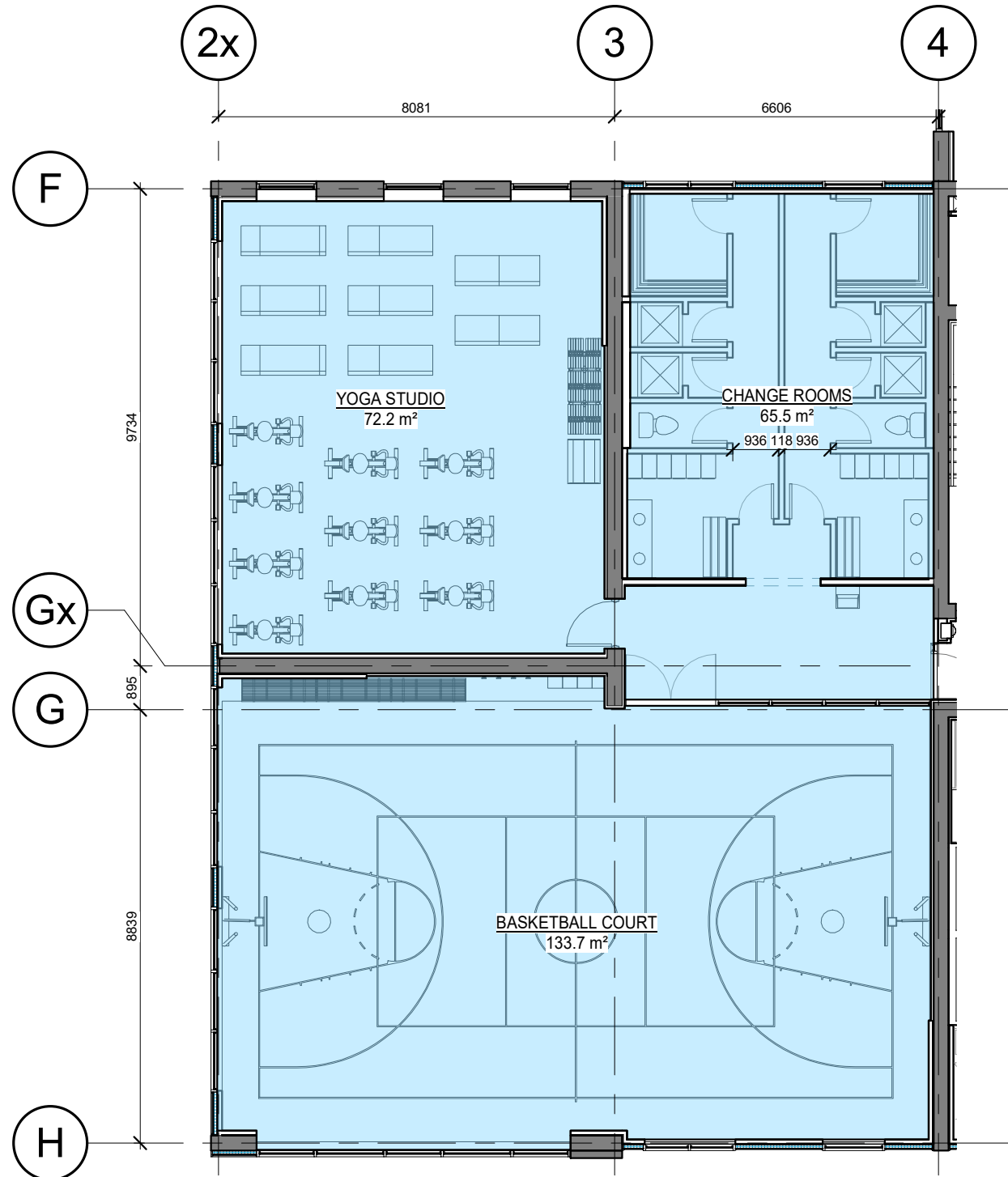

1 LEVEL 14 AMENITY SPACE
1 : 125

1	2019-11-27	ISSUED FOR OPA/ZBA SUBMISSION
No.	Date	Revision

Project No 18025
 Issue Date 2019-10-18
 Drawn by MSW
 Checked by TJM
 Plot Date / Time 2019-11-27 1:32:52 PM



354 KING STREET WEST

ENLARGED FLOOR PLAN - LEVELS 14 & 15



Drawing Scale 1 : 125
 Status ISSUED FOR OPA/ZBA
 Drawing No. A7.4

Do not scale drawings. Contractors must check and verify all dimensions and report any discrepancies to the Architect before proceeding with the work. All documents remain the property of the Architect. Unauthorized use, modification, and/or reproduction of these documents is prohibited without written permission. The Contract Documents were prepared by the Consultant for the account of the Owner. The material contained herein reflects the Consultant's best judgment in light of the information available to him at the time of preparation. Any use which a third party makes of the Contract Documents, or any reliance on or decisions to be made based on them are the responsibility of such third parties. The Consultant accepts no responsibility for damages, if any, suffered by any third party as a result of decisions made or actions based on the Contract Documents.
 C:\Users\mwhite\Desktop\Locals\18025 - 354 King St, Hamilton - V10.0_mWhite66EDL.rvt

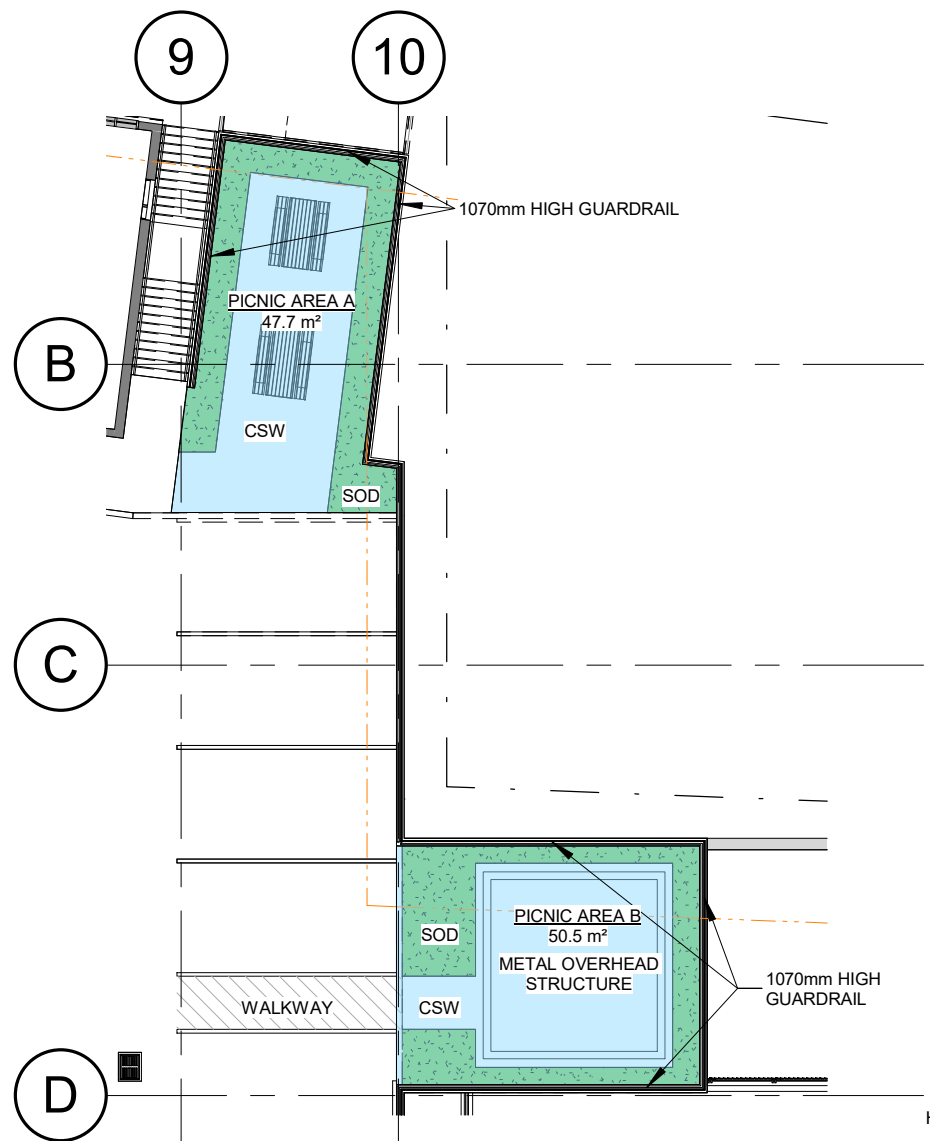

3 OUTDOOR AMENITIES
1 : 200

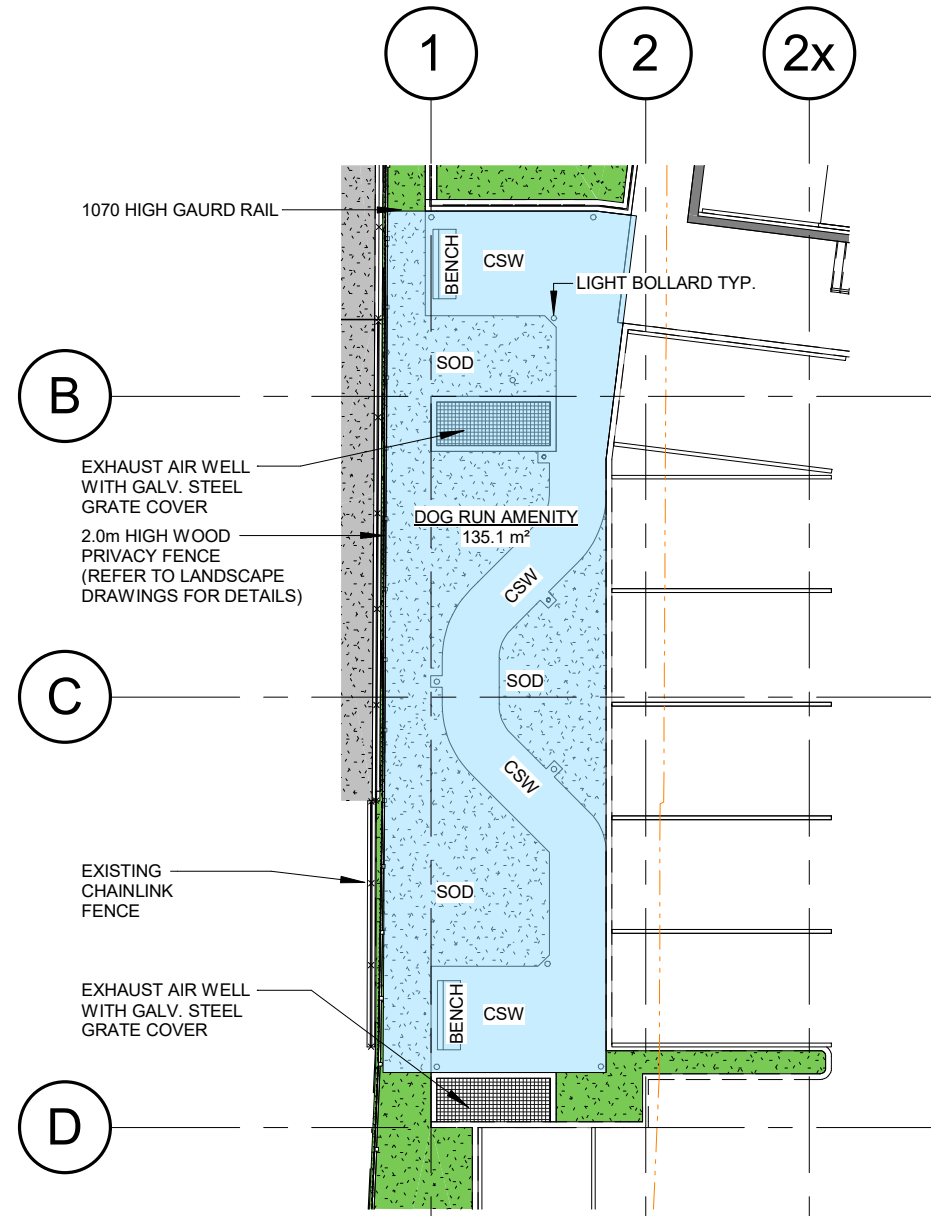

1 DOG WALK AMENITY
1 : 200

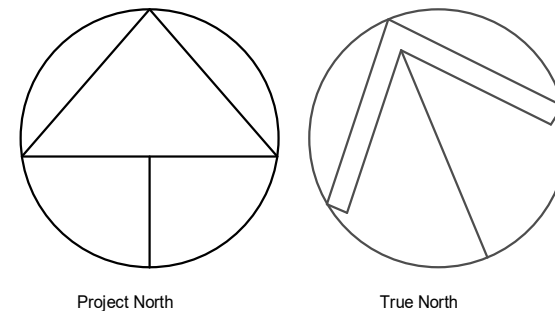

1	2019-11-27	ISSUED FOR OPA/ZBA SUBMISSION
No.	Date	Revision

Project No: 18025
 Issue Date: 2019-10-18
 Drawn by: MSW
 Checked by: TJM
 Plot Date / Time: 2019-11-27 1:32:56 PM



354 KING STREET WEST

AMENITY AREA PLANS



Drawing Scale: 1 : 200
 Status: ISSUED FOR OPA/ZBA
 Drawing No.

A7.5

Do not scale drawings. Contractors must check and verify all dimensions and report any discrepancies to the Architect before proceeding with the work. All documents remain the property of the Architect. Unauthorized use, modification, and/or reproduction of these documents is prohibited without written permission. The Contract Documents were prepared by the Consultant for the account of the Owner. The material contained herein reflects the Consultant's best judgment in light of the information available to him at the time of preparation. Any use which a third party makes of the Contract Documents, or any reliance on or decisions to be made based on them are the responsibility of such third parties. The Consultant accepts no responsibility for damages, if any, suffered by any third party as a result of decisions, made or actions based on the Contract Documents.
 C:\Users\mwhite\Desktop\Locals\18025 - 354 King St, Hamilton - V10.0_mWhite66EDL.rvt

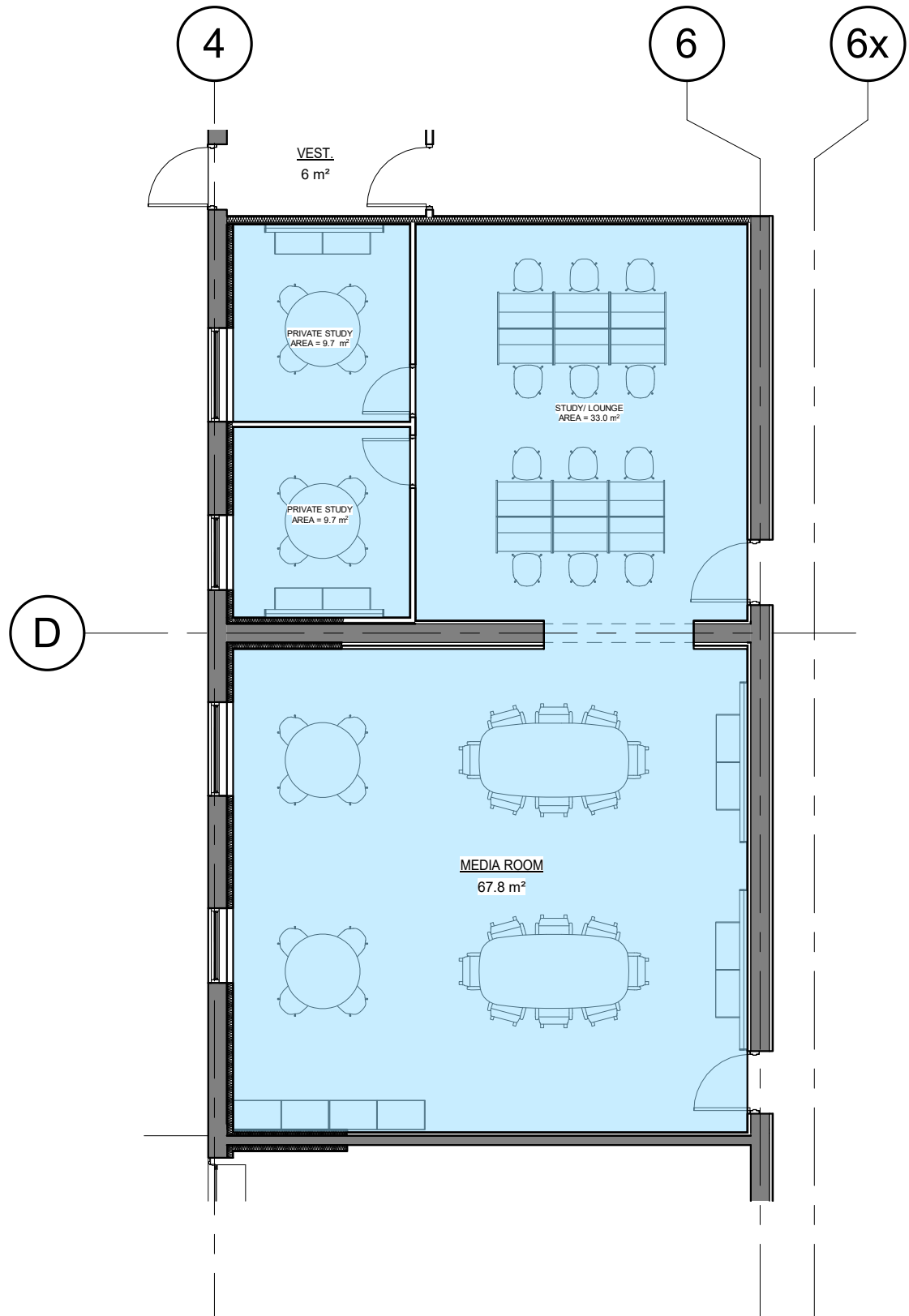

2 STUDY/MEDIA ROOM
1 : 100

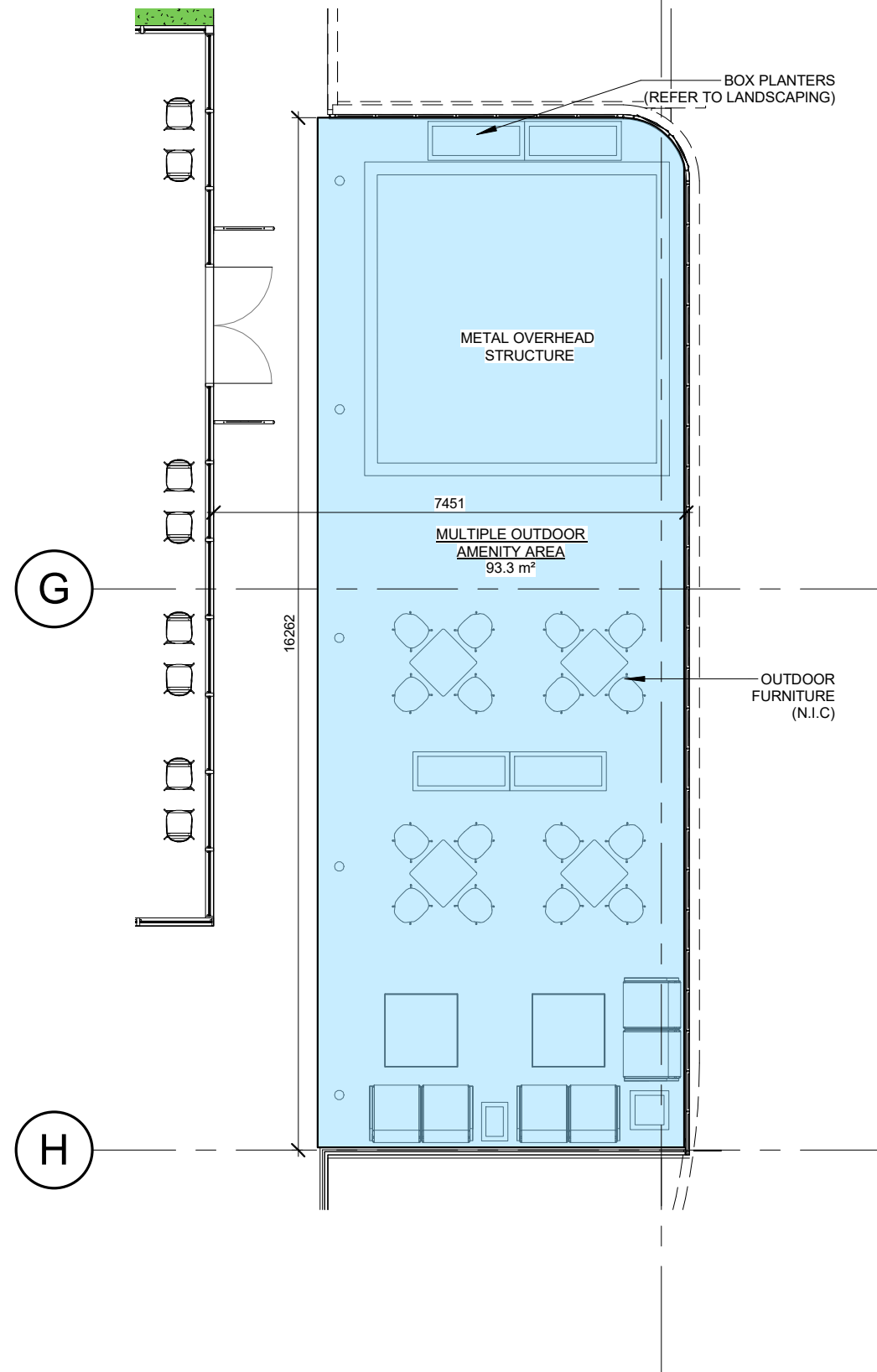

1 OUTDOOR SEATING AREA
1 : 100

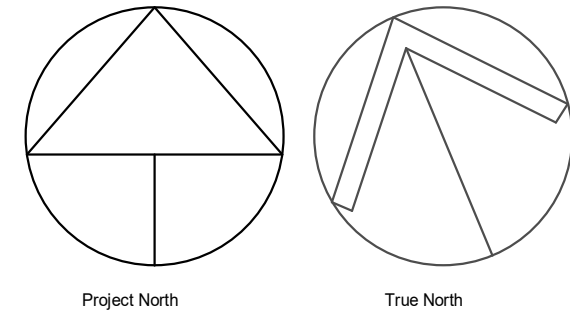

No.	Date	Revision
-----	------	----------

Project No 18025
 Issue Date 2019-10-18
 Drawn by MSW
 Checked by TJM
 Plot Date / Time 2019-11-27 1:32:58 PM



354 KING STREET WEST

AMENITY AREA PLANS



Drawing Scale 1 : 100
 Status ISSUED FOR OPA/ZBA
 Drawing No.

A7.6

Do not scale drawings. Contractors must check and verify all dimensions and report any discrepancies to the Architect before proceeding with the work. All documents remain the property of the Architect. Unauthorized use, modification, and/or reproduction of these documents is prohibited without written permission. The Contract Documents were prepared by the Consultant for the account of the Owner. The material contained herein reflects the Consultant's best judgment in light of the information available to him at the time of preparation. Any use which a third party makes of the Contract Documents, or any reliance on or decisions to be made based on them are the responsibility of such third parties. The Consultant accepts no responsibility for damages, if any, suffered by any third party as a result of decisions, made or actions, based on the Contract Documents.
 C:\Users\mwhite\Desktop\Locals\18025 - 354 King St, Hamilton - V10.0_mWhite66EDL.rvt

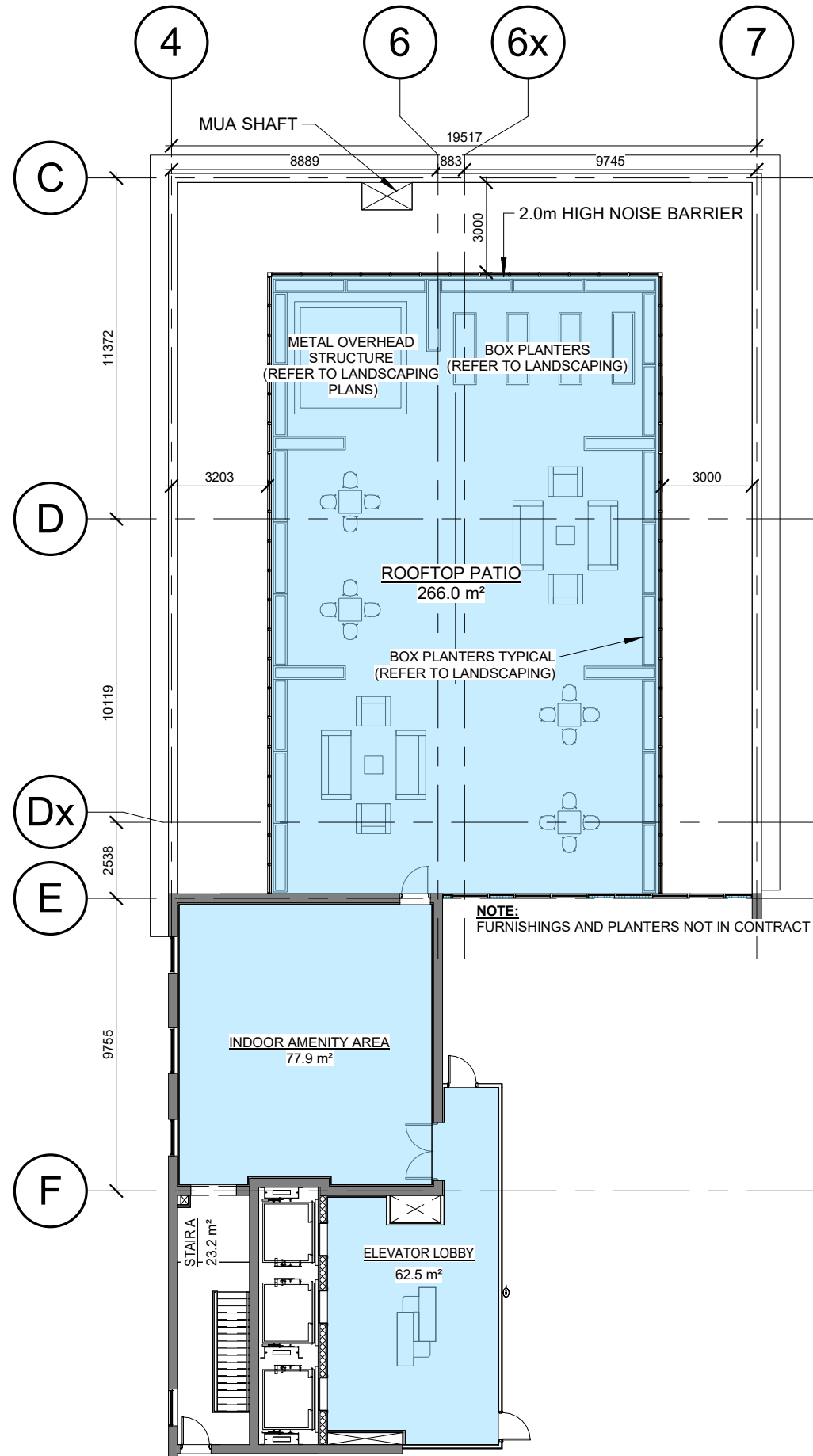

2 MECHANICAL PENTHOUSE FLOOR PLAN
 1 : 200

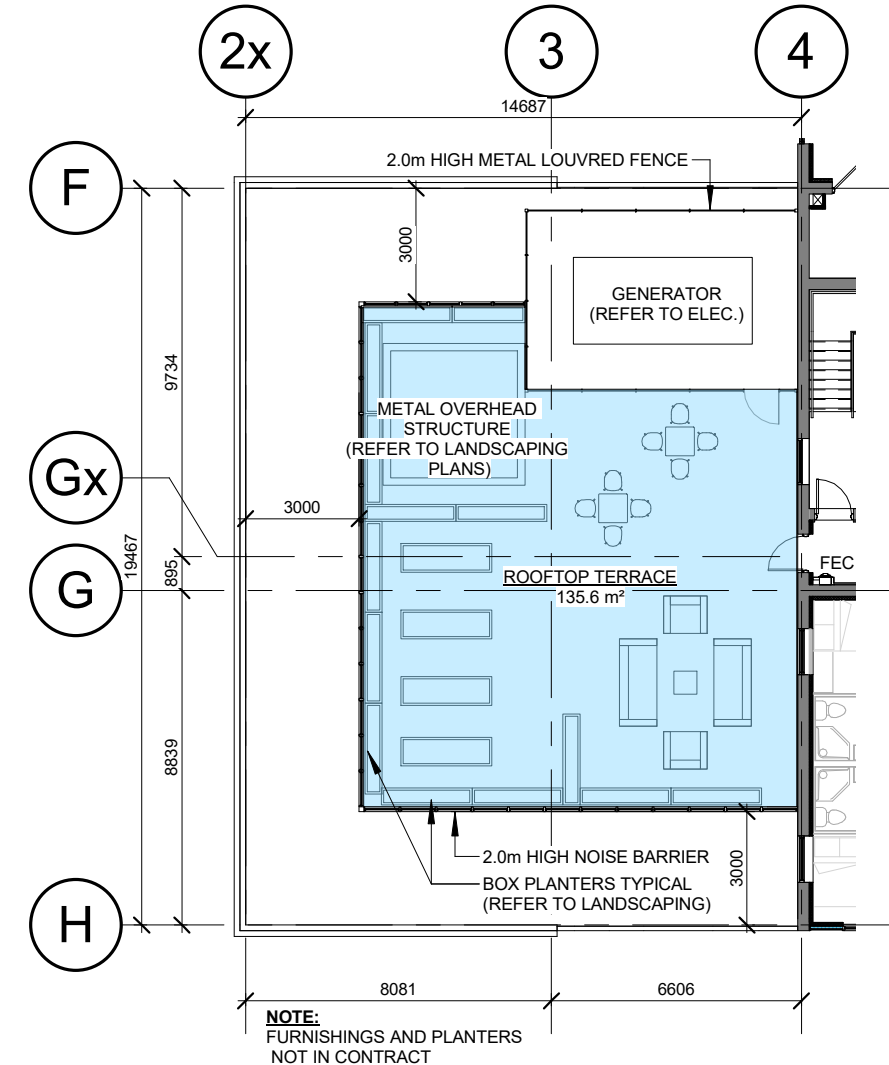

1 LEVEL 16 - 25 FLOOR PLAN (TYPICAL)
 1 : 200

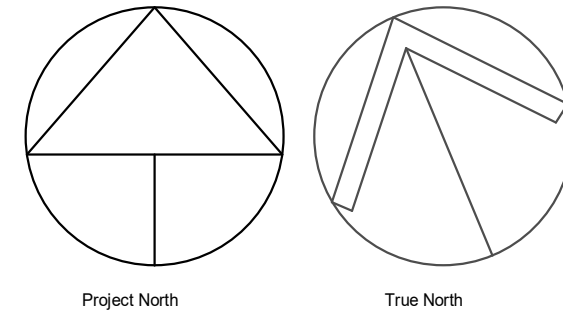

1	2019-11-27	ISSUED FOR OPA/ZBA SUBMISSION
No.	Date	Revision

Project No. 18025
 Issue Date 2019-10-18
 Drawn by MSW
 Checked by TJM
 Plot Date / Time 2019-11-27 1:33:01 PM



354 KING STREET WEST

AMENITY AREA PLANS



Drawing Scale 1 : 200
 Status ISSUED FOR OPA/ZBA
 Drawing No.

A7.7