

***NOTE:**
BASED ON THE CITY'S COUNCIL ADOPTED TREE PROTECTION GUIDELINES (REVISED OCTOBER 2010), THE TREE MANAGEMENT PROFESSIONAL (I.E., CERTIFIED ARBORIST, REGISTERED PROFESSIONAL FORESTER, OR LANDSCAPE ARCHITECT) IS TO PREPARE A VERIFICATION OF TREE PROTECTION LETTER TO THE SATISFACTION OF THE DIRECTOR OF PLANNING. THIS IS TO ENSURE THAT ALL TREE PROTECTION MEASURES HAVE BEEN IMPLEMENTED. THIS CORRESPONDENCE IS TO BE PROVIDED PRIOR TO ANY ON-SITE WORKS.

***NOTE:**
ALL VEGETATION TO BE REMOVED BETWEEN SEPT. 1 AND MARCH 30 TO AVOID THE BREEDING SEASON (MARCH 31 TO AUGUST 31)

***NOTE:**
TO ENSURE THAT EXISTING COVER IS MAINTAINED, THE CITY REQUIRES 1 FOR 1 COMPENSATION FOR ANY TREE (10 CM DBH OR GREATER) THAT IS PROPOSED TO BE REMOVED. A MINIMUM REQUIREMENT OF 67 NEW TREES ARE REQUIRED TO BE PROPOSED ON SITE.

LEGEND

- TREES TO BE REMOVED
- TREES TO BE RETAINED
- TREES PROTECTION FENCE

TEMPORARY TREE PROTECTION FENCING (POST SECTION AND ELEVATION, NTS)

CITY OF HAMILTON TREE PROTECTION FENCING

October 2003

323133.99-87 N.T.S.

LOCATION MAP

GENERAL NOTES

THE LOCATION OF PROPERTY LINES, ELEVATIONS AND FACILITIES ON THIS PLAN WERE DRAWN ON THE BASIS OF A DIGITAL SITE PLAN OR SURVEY DATA PROVIDED BY OTHER CONSULTANTS.

IT IS THE RESPONSIBILITY OF THE CLIENT AND HIS CONTRACTORS TO CONFIRM THE ACCURACY OF THE SETBACKS, LOCATIONS AND GRADES ETC. ANY VARIATIONS BETWEEN EXISTING CONDITIONS AND THIS PLAN SHOULD BE ADJUSTED ON SITE AND REPORTED TO THE CONSULTING LANDSCAPE ARCHITECT TO DETERMINE THE IMPACT OF THE VARIATIONS ON THE SUITABILITY OF THE PROPOSED DEVELOPMENT.

CONSTRUCTION MUST CONFORM TO ALL CODES AND REQUIREMENTS OF AUTHORITIES HAVING JURISDICTION.

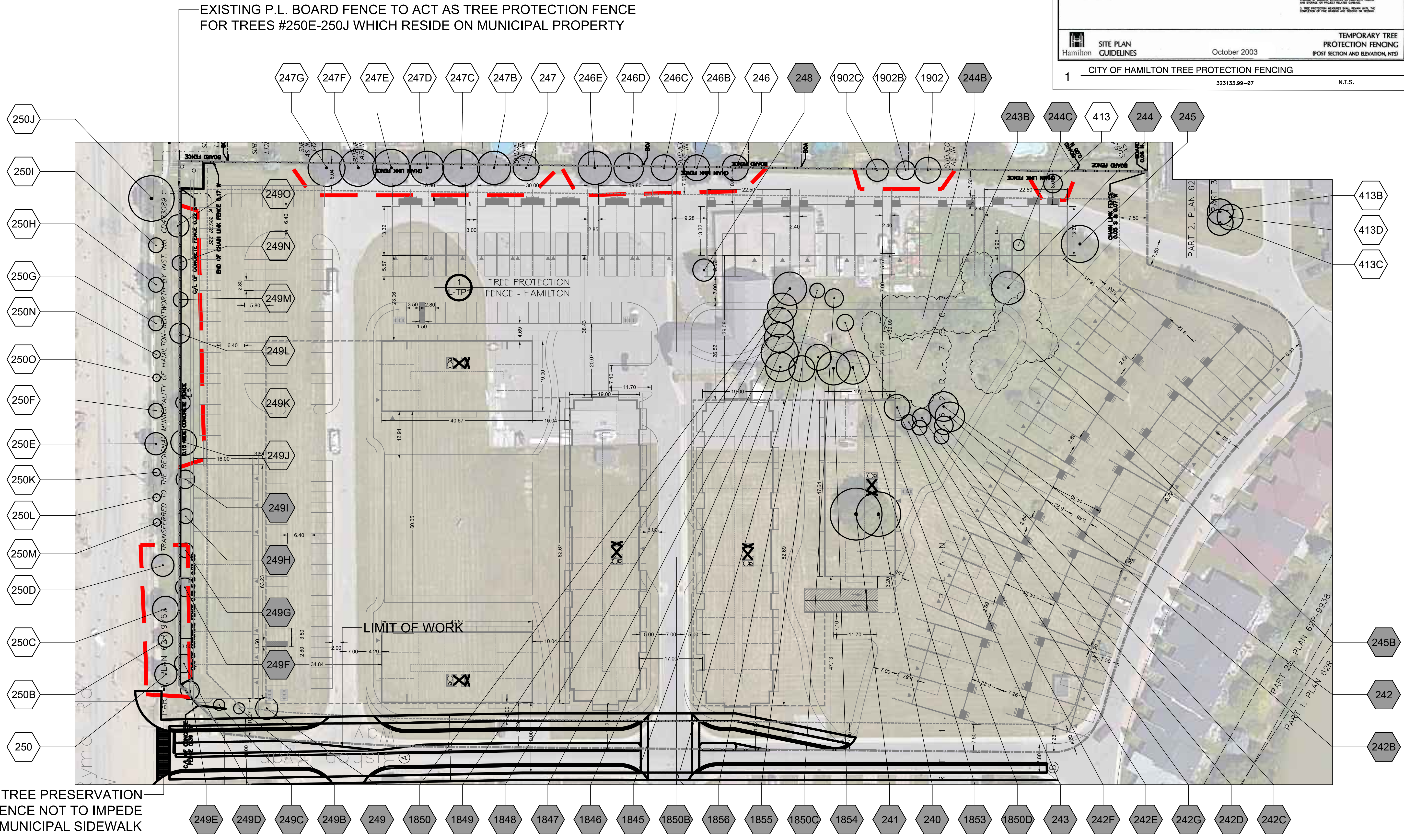

REVISIONS

| NO. | DATE | NOTES | KL | BY |
|-----|------------|-------|----|----|
| 1 | 2023-02-17 | TIPP | | |

THESE LANDSCAPE DRAWINGS SHALL ONLY BE USED FOR THE PURPOSES INDICATED BELOW AS NOTED AND WHEN SIGNED BY THE CONSULTING LANDSCAPE ARCHITECT.

| | | | |
|--|-------------|--|--------------|
| | CONCEPTUAL | | TENDER |
| | PRELIMINARY | | CONTRACT |
| | SITE PLAN | | CONSTRUCTION |
| | PERMIT | | AS-BUILT |

KLA
Landscape Architects & Consulting Arborists
230 Westway Road S Unit 308, Ajax, ON L1S 7J5
O: (905) 838-5599 | E: info@kla.ca | Web: www.kla.ca

THESE DRAWINGS ARE INSTRUMENTS OF SERVICE AND THE LANDSCAPE ARCHITECT RETAINS OWNERSHIP OF THESE DRAWINGS. THEY ARE FOR SITE PLAN APPROVAL ONLY AND MAY REQUIRE FURTHER CONSTRUCTION DETAILING AND COORDINATION WITH OTHER ASSOCIATED PROFESSIONAL DESIGN SERVICES BEFORE ACTUAL TENDER AND CONSTRUCTION COMMENCES. DIMENSIONS ARE TO BE VERIFIED PRIOR TO CONSTRUCTION. DRAWINGS ARE NOT TO BE SCALED. IT IS ADVISED THAT CONTRACTORS CONTACT THE LANDSCAPE ARCHITECT PRIOR TO CONSTRUCTION TO ENSURE THE USE OF THE LATEST REVISED DRAWINGS. THE LANDSCAPE ARCHITECT IS NOT LIABLE FOR ERRORS OR OMISSIONS ARISING FROM UTILIZATION OF THESE PLANS BEFORE THE SAID DRAWINGS ARE SCALED, SIGNED AND DATED, AND THE LANDSCAPE ARCHITECT IS CONTRACTED TO PROVIDE CONSTRUCTION ADMINISTRATION AND CERTIFICATION SERVICES BY THE OWNER. ALL APPARENT DISCREPANCIES ARE TO BE REPORTED IN WRITING TO THE LANDSCAPE ARCHITECT BEFORE CONSTRUCTION COMMENCES.

PROJECT: SPA FILE #
393 RYMAL ROAD WEST
HAMILTON, ON L9B 1V2

DRAWING: **TREE PRESERVATION PLAN**

DRAWN BY: KL SCALE: 1:500
CHECKED BY: TJM DATE: 2023-02-14
JOB NO.: 2023-010

L-TP1
DRAWING 1 of 2

File #2023-010

